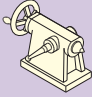
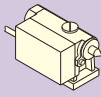
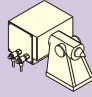

Tailstock

Compatible Rotary Tables

Tailstock type	Manual	Hydraulic	Pneumatic
NC Rotary Table			
RN-100	TL-110M	—	—
RWE/RWA/RWH-160 RWM-160	TL-135M	TLH-135	TLP-135M
RBS/RBH-160 RBM-160 RWE/RWA/RWH-200 RWA/RWH-250 RWB-250 RWM-200/250	TL-160M	TLH-160	TLP-160M
RBS/RBH-250 RWA/RWH-320 RWB-320 RWM-320	TL-210M	TLH-210	—
RBS/RBH-320 RWB-400	TL-255M	TLH-255	—
RWB-500	TL-310M	—	—
RWB-630	TL-400M	—	—
RCV-800	TL-530M	—	—

Order Code

T L - 160M

Center height

Alphabet	Type
N/A	Manual
H	Hydraulic
P	Pneumatic

Example

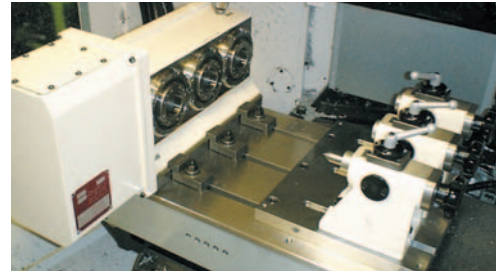

Manual Tailstock

TL-110M, 135M

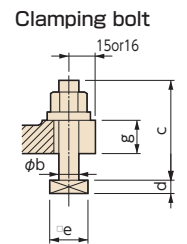
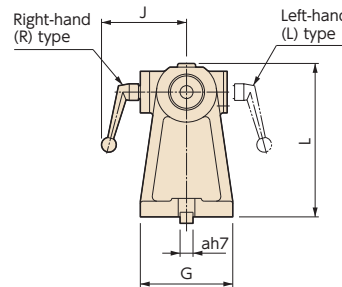
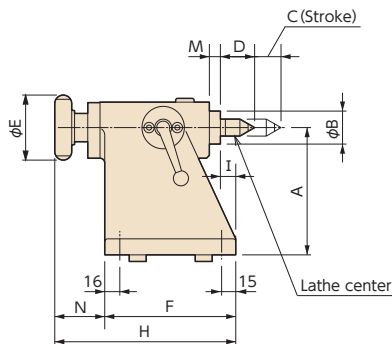

TL- M

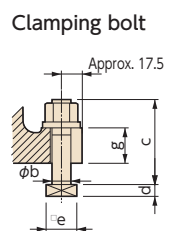
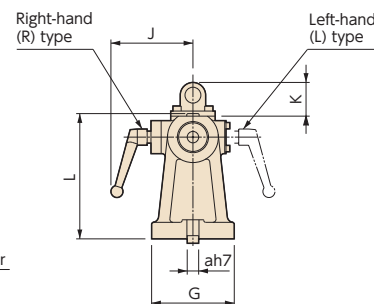
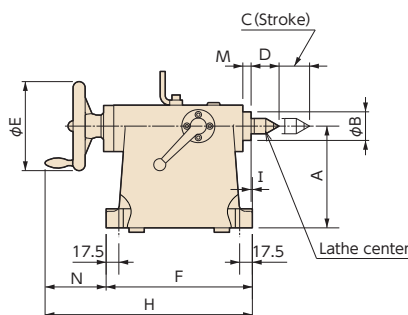

Dimensions

Unit: mm

Order Code	Morse taper	Center height A	Center dia. B	Stroke C	Lathe center D	Handle dia. E	Base dimensions F×G	H	I	J	K	L	M	N	a	b	c	d	e	g	Weight kg
TL-110M	MT2	110	35	28	36	70	139×100	192	16	92	—	141	12	53	14	12	55	8	23	20	8
TL-135M	MT2	135	35	28	36	70	139×100	192	16	92	—	166	12	53	14	12	55	8	23	20	9
TL-160M	MT3	160	45	47	44	140	230×130	328	2	129	53	197	13	98	18	16	75	11	28	30	22
TL-190M	MT3	190	45	47	44	140	230×140	328	2	129	53	227	13	98	18	16	75	11	28	30	24
TL-210M	MT3	210	45	47	44	140	230×146	328	2	129	53	247	13	98	18	16	75	11	28	30	26
TL-235M	MT4	235	50	51	52.5	160	270×160	381	12	132	53	274	8	113	18	16	80	11	28	35	30
TL-255M	MT4	255	50	51	52.5	160	270×170	381	12	132	53	294	8	113	18	16	80	11	28	35	38
TL-310M	MT4	310	60	51	52.5	180	315×220	422	15.5	154	68	354	9.5	107	18	16	85	11	28	40	63
TL-400M	MT4	400	60	51	52.5	180	315×240	422	15.5	154	68	444	9.5	107	18	16	85	11	28	40	76
TL-530M	MT4	530	80	66	52.5	225	410×290	528	29	165	68	594	6	118	22	20	95	13	32	40	138



TL-135M

Example of Pneumatic Tailstock

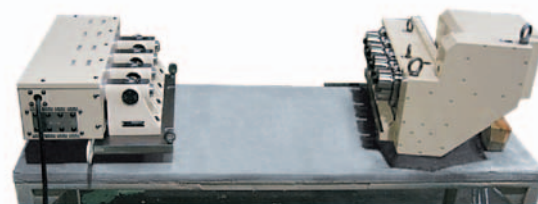

Hydraulic Tailstock

TLH-□□□



TLH-160

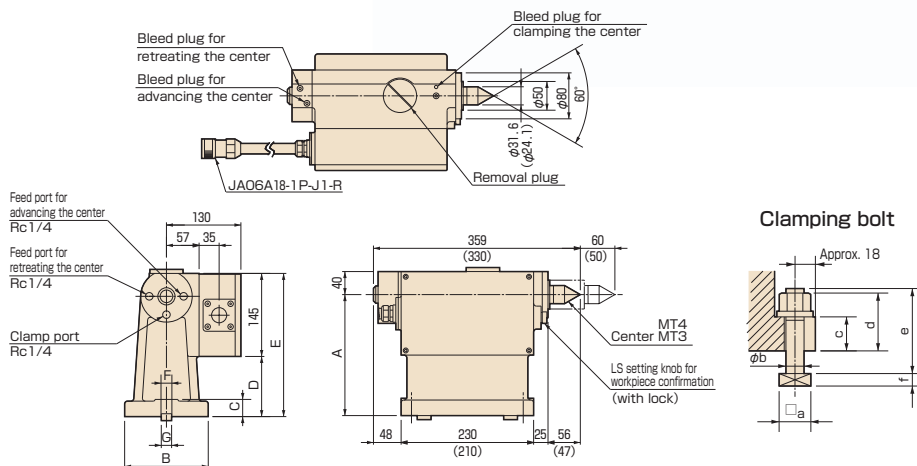

Note 1: Dimensions in parentheses are for the TLH-135.
 Note 2: Specify the cable length when placing an order.

Dimensions and specifications

Unit: mm

Order Code	A	B	C	D	E	F	Carbide center	Hydraulic MPa	Center thrust force N	Center clamp torque N	Weight kg
TLH-135	135	110	25	30	175	19	MT3	1.5 to 6.8	1,670	2,450	28
TLH-160	160	130	30	55	200	19	MT4		2,352		33
TLH-210	210	146	30	105	250	19	MT4		2,352		36
TLH-255	255	170	35	150	295	19	MT4		2,352		40

Clamping bolt dimensions

Unit: mm

Order Code	G	a	b	d	e	f
TLH-135	14	23	12	42	60	8
	16	26	16	46	70	10
	18	28	16	46	70	11
TLH-160 TLH-210	14	23	12	47	65	8
	16	26	16	51	75	10
	18	28	16	51	75	11
TLH-255	16	26	16	56	75	10
	18	28	16	56	80	11
	20	32	18	60	90	11

* The table above shows the center thrust force and clamp torque when the hydraulic pressure is 3.5MPa.

RBS

RBH

RBM

TBS

RWE/RWA
RN

RWH

RWA-B

RWB

RWB-K

RCB

RCH

RCV

Multi-Spindle
RWM

TWA/TN

TWS

TWB

Multi-Spindle
TWM

RDS

TDS
TDB

NC
Controllers

Accessories

Options

Technical
Information