

Standard type

TWB

TWB-320•450•630•1000

Large tilting models that enable 5-face machining and slanted-hole machining with single chucking of workpiece. Suitable for machining of component parts for heavy industries such as aircraft, power generator and construction machine industry.

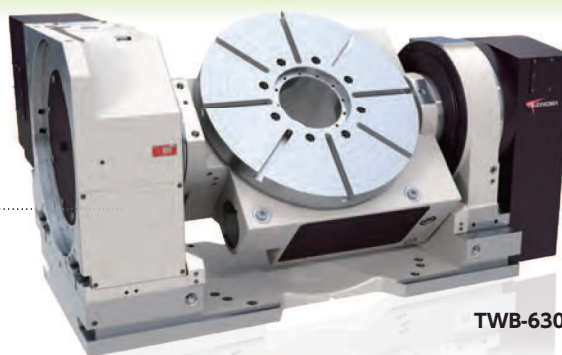

TWB-630

Specifications

Unit: mm

	TWB-320		TWB-450		TWB-630		TWB-1000			
Tilt range	-30° to +110°		-30° to +110°		-110° to +110°		-30° to +110°			
Table diameter	φ 320		φ 450		φ 630		φ 1,000			
Table height at 0° position	355		415		585		650			
Center height at 90° position	255		415		450		650			
Center bore	Nose diameter	φ 105H7		φ 150H7		φ 220H7		φ 360H7		
	Through-bore	φ 80		φ 120		φ 181		φ 310		
Table T-slot width	14H7		14H7		18H7		18H7			
Guide block width	18h7		18h7		18h7		—			
Servo motors (for FANUC)	Rotary axis	α iF8	α iF12	α iF12	α iF22	α iF12	α iF12	α iF12	α iF30	
	Tilt axis	—	—	—	—	—	—	—	—	
Inertia converted into motor shaft	× 10 ⁻³ kg·m ²		1.8		2.95		5.31		5.55	
Speed reduction ratio	1/90		1/120		1/90		1/120		1/180	
Table max. rpm	min ⁻¹		22.2		16.6		22.2		16.6	
(Motor rpm: 2,000min ⁻¹)	—		—		—		—		—	
Clamp system Supplied pressure	Hydraulic or air-hydraulic (Option)	Hydraulic or air-hydraulic (Option)		Hydraulic or air-hydraulic (Option)		Hydraulic or air-hydraulic (Option)		Hydraulic or air-hydraulic (Option)		
	Hydraulic	Hydraulic		Hydraulic		Hydraulic		Hydraulic		
Clamp torque	N·m	2,200 (3.5MPa)	3,100 (3.5MPa)	3,100 (3.5MPa)	11,000 (3.5MPa)	7,600 (3.5MPa)	13,100 (3.5MPa)	16,000 (3.5MPa)	32,000 (3.5MPa)	
		3,000 (4.9MPa)	4,700 (4.9MPa)	4,700 (4.9MPa)	16,000 (4.9MPa)	—	—	—	—	
Indexing accuracy (the sum)	arcsec	20		—		15		—		
Tilting accuracy (the sum) Tilt 0° to 90°	arcsec	—		60		—		60		
Net weight	kg	470		1,300		1,750		6,000		
Allowable work weight	kg	0° (Horizontal)		0°		0°		0°		
		0° to 90° (Tilting)		90°		90°		90°		
Allowable work moment	N·m	W×L		W×L		W×L		W×L		
		—		—		—		—		
Allowable load (when table is clamped)	N	F		F		F		F		
		—		—		—		—		
Allowable load (when table is clamped)	N·m	F×L		F×L		F×L		F×L		
		—		—		—		—		
Allowable work inertia	kg·m ²	J = $\frac{W \cdot D^2}{8}$		J = $\frac{W \cdot D^2}{8}$		J = $\frac{W \cdot D^2}{8}$		J = $\frac{W \cdot D^2}{8}$		
		—		—		—		—		

CE correspondence model

Tech.Info Servo motors of other manufacturers **P.70** Workpiece mounting space for tilting rotary tables **P.72**

Option High-precision Spec. **P.66** Pull Stud **P.68** Rotary Joint **P.68** Air-hydraulic Booster **P.69**

(The page numbers refer to the General Catalog.)

TSUDAKOMA Corp.

Nonoichi Plant 5-100 Awada, Nonoichi, Ishikawa 921-8529 Japan
 Phone: +81-76-294-5111 Fax: +81-76-294-5157
 www.tsudakoma.co.jp E-mail:ksales@tsudakoma.co.jp

Dimensions

Unit: mm

TWB-320

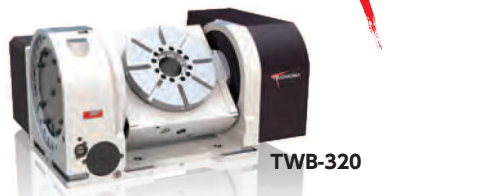
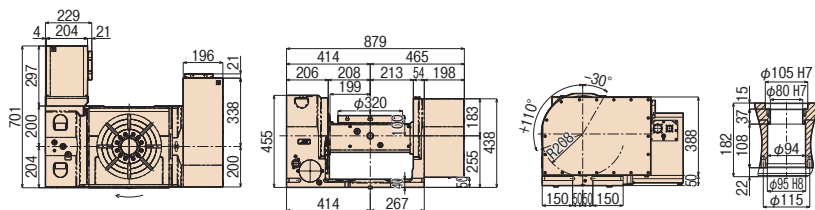

TWB-450R

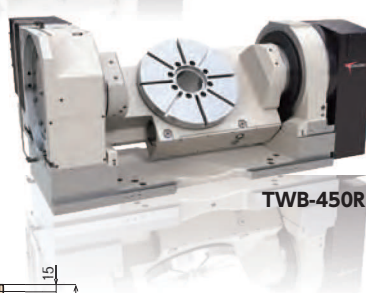
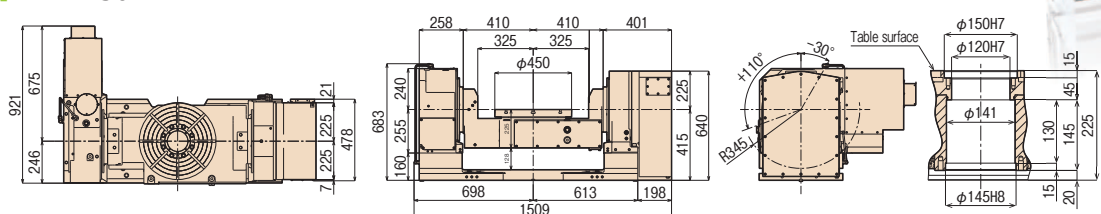

Workpiece can be loaded up to $\phi 630$ mm.

TWB-630

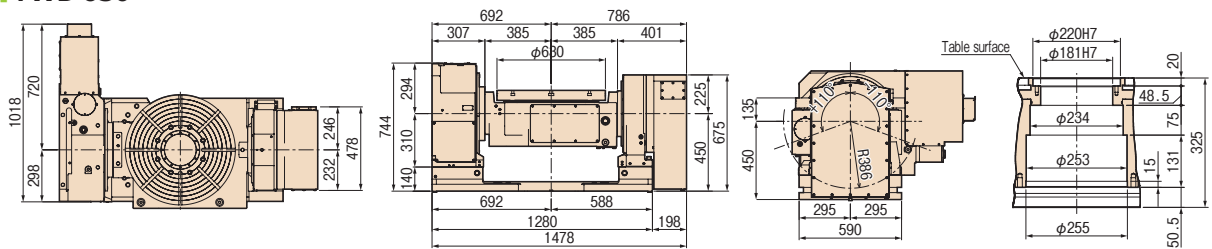

TWB-1000

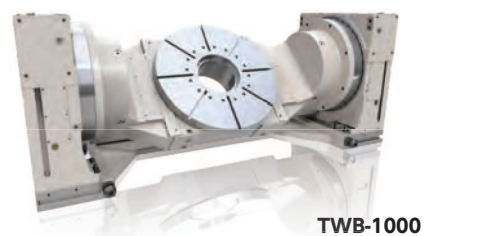
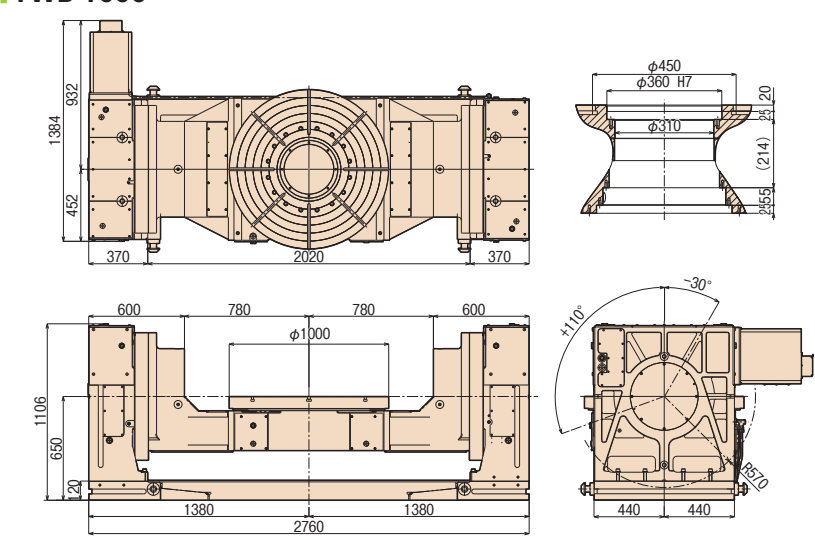

Workpiece can be loaded up to $\phi 1,500$ mm.
Details **P.72**

Note: The above dimensions are for FANUC servo motors. The dimensions of servo motors of other manufacturers may be larger.

Clamping block and bolt

	Type	Q'ty	Layout	T-slot pitch	T-slot width	A	B	C	D	E	F	G	H	I	J	K	L	M
TWB-320	I	4	a b	140 to 190 70 to 150	18	25	12	80	12	33	35	22	21	11	65	40	28	16
TWB-450	I	4	a b	80 to 500 80 to 200	18	40	20	110	18	42	50	25	21	11	70	46	28	16
TWB-630	I	4	a b	80 to 500 80 to 200	18	40	20	110	18	42	50	25	21	11	70	46	28	16
TWB-1000	IV	8	—	—	24	40	18	63	18	15	30	58	20	14	105	60	38.2	20

Note 1: * In the case of layout b, contact us for the details about mounting.

Note 2: When using a machine with a T-slot pitch other than the above, use suitable clamping blocks and bolts that are available on the market, or order custom-made ones from TSUDAKOMA. (Option)

